

| REVISION | DESCRIPTION | DATE |
|----------|-------------|------|
|----------|-------------|------|

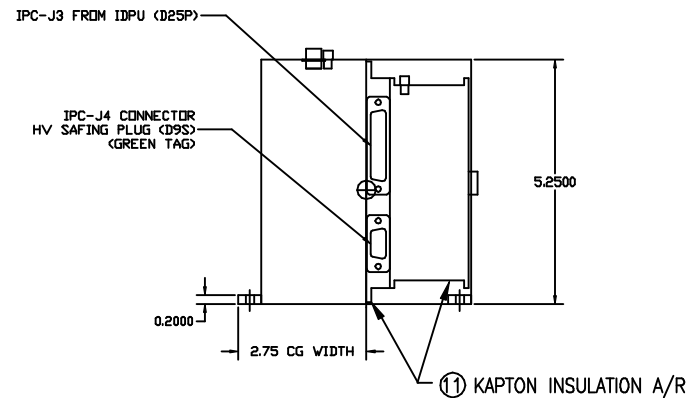
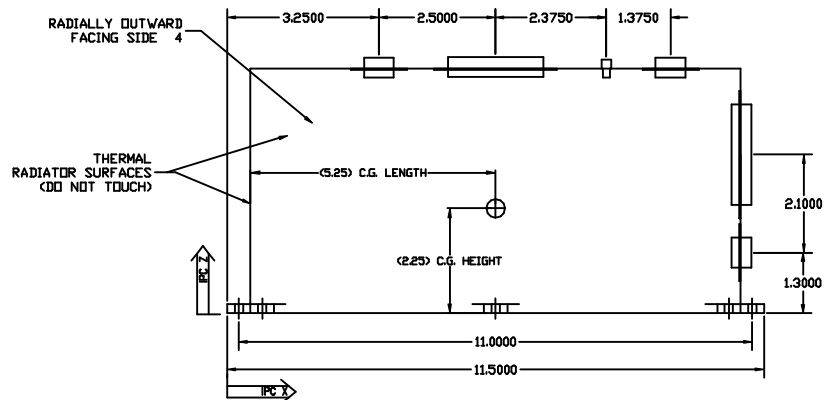
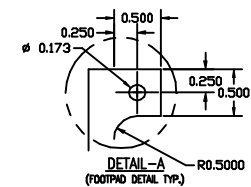
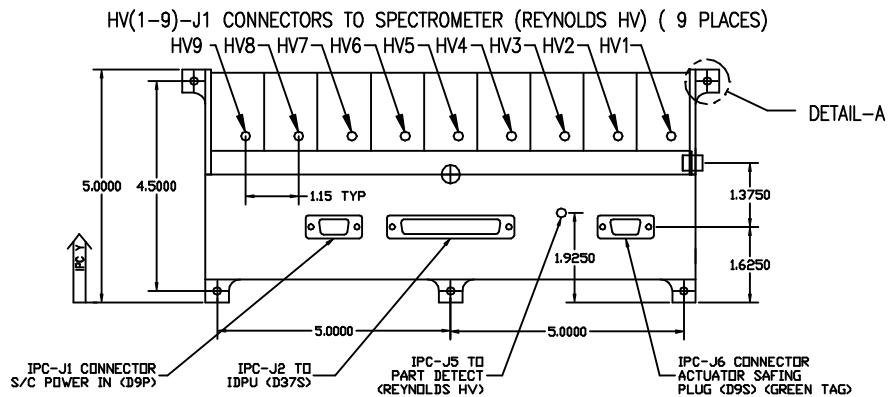

NOTES (UNLESS OTHERWISE SPECIFIED):

1. MASS: 3.6kg. MAX (REFERENCE ONLY, SEE ICD HSI_SYS_010)
2. POWER: 8W NOMINAL/20W MAX (REFERENCE ONLY, SEE ICD HSI_SYS_001)
3. TEMPERATURE: -30°C TO 50°C (REFERENCE ONLY, SEE ICD HSI_SYS_001)
- ④ FIELD OF VIEW/ALIGNMENT REQUIREMENTS: RADIALLY OUTWARD SIDE
5. HANDLING RESTRICTIONS: NONE
6. SPECIAL ENVIRONMENTAL CONSTRAINTS: NONE
7. EMI/EMC/ESD/MAGNETIC SENSITIVITY: NONE
8. RED/GREEN TAG ITEMS AND PROTECTIVE COVERS: SAFING PLUGS (2)
- ⑨ ALL OTHER SURFACES COVERED BY MLI THERMAL BLANKETS
10. CENTER OF MASS (REFERENCE ONLY, SEE ICD HSI_SYS_010)
- ⑪ USE KAPTON A/R TO INSURE HVPS ENCLOSURE IS ELECTRICALLY ISOLATED FROM S/C BUS

| | | | | | |
|-----------------------|----------------|---|----------------------------|---|------------------|
| MATERIAL: VARIOUS | | U.S. SPCL. THIRD ANGLE PROJECTIONS ① ② ③ | | SPACE SCIENCES LABORATORY UNIVERSITY OF CALIFORNIA, BERKELEY 94720 (510) 642-7297 FAX: (510) 643-8302 | |
| FORM: VARIOUS | | STANDARD DIMENSIONS IF NOT SPECIFIED 0.1XX - .00" ANGLES SURFACES 0.1XX - .00" 0.1° | | TITLE: HES1 INSTRUMENT POWER CONVERTER (IPC) | |
| DESIGN BY: R PRATT | NO/YR: 9/98 | SCALE - DO NOT SCALE - DIMENSIONS IN INCHES | DRAWING NO. HSI_SYS_012 | REVISION: F | SHEET: 1 OF 1 |